

# SUN CITY WEST MEDICAL ARTS CENTER

# Medical Office Space for Lease on Campus at Banner Del E. Webb



14300 W GRANITE VALLEY DR | SUN CITY WEST, AZ 85375

OWNED BY

LEASING BY

HEALTHCARE  
REALTY

**km** Kidder  
Mathews



## SUN CITY WEST MEDICAL ARTS CENTER

**ADDRESS** 14300 W Granite Valley Dr.,  
Sun City West, AZ 85375

**BLDG SIZE** 34,155 SF

**BUILDINGS** 5

**PARKING** Patient-friendly, drive  
up parking and covered  
parking available



# SITE PLAN

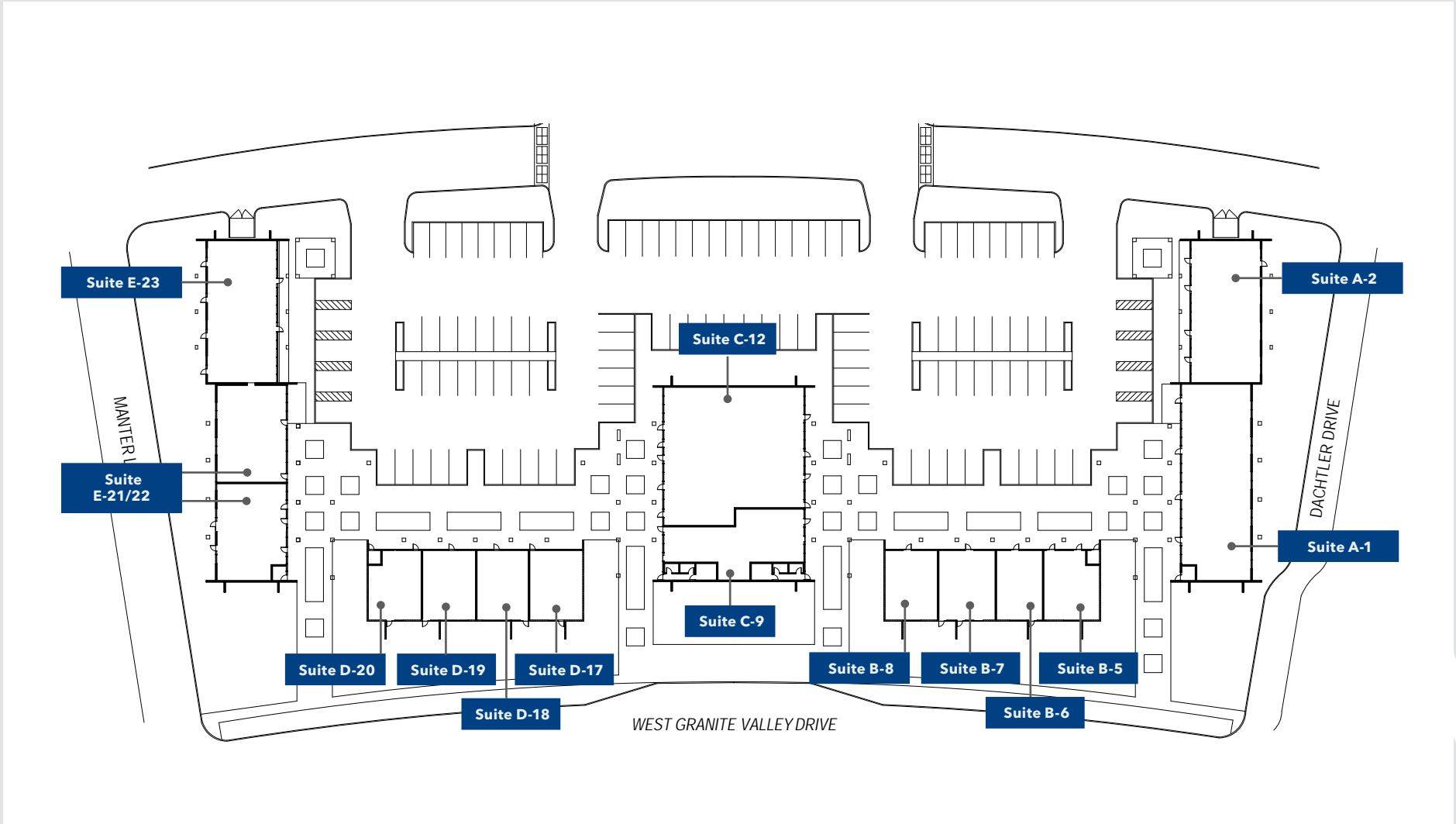

**SUN CITY WEST  
MEDICAL ARTS  
CENTER**

# Property Highlights



## ACCESS

Easy access to Loop 303 near Grand Avenue



## HEALTHCARE SYNERGY

Services at Banner include surgical care, critical care, orthopedic surgery, cardiology, obstetrics and gynecology



## LOW COST

Attractive low cost of occupancy with generous T.I. packages available



## UNBEATABLE LOCATION

On campus at Banner Del E Webb, a 404-bed acute care facility



## COVERED PARKING

Ample parking ratio with covered parking available for physicians



## BUILDING SIGNAGE

Available with frontage on W. Granite Valley Dr



Banner Del E. Webb  
Medical Center

SUN CITY WEST  
MEDICAL ARTS  
CENTER

## BANNER DEL E. WEBB MEDICAL CENTER

404 licensed beds with the ability to add an additional 92

Campus serves as a base for a BannerAir helicopter

Eighth largest hospital in the valley, providing acute, non-profit care

Strategically  
located on campus  
at Banner Del E.  
Webb Medical  
Center.



24,798

VPD ON MEEKER BLVD



\$76,926

AVERAGE 3-MILE HH INCOME



5 min

DRIVE TIME TO LOOP 303

# SUN CITY WEST MEDICAL ARTS CENTER

For additional leasing information, contact

**RACHAEL THOMPSON**

Senior Vice President  
602.513.5122  
rachael.thompson@kidder.com

**PERRY GABUZZI, CCIM**

Executive Vice President  
602.513.5116  
perry.gabuzzi@kidder.com

OWNED BY



**HEALTHCARE  
REALTY**

LEASING BY

 **Kidder  
Mathews**